



Inverter
SYNERGY 

*Split System 6.25-20 Tons
Light Commercial Inverter System
TYH/MYV/TYE/CLCP/TYA/TYK
R410A Series 50Hz*

TRANE
TECHNOLOGIES



Light Commercial Inverter System



The introduction of DC Inverter compressor driven by the most advanced control technology is designed to provide more precise operation and improved system efficiency to reach maximum SEER 14.5 (averagely improved 42% from Fixed speed type). The compressor speed is adapted to match the fluctuating cooling load of the buildings while ensuring the appropriate variable supply of cooling.

Space Saving with Smaller Footprint

Trane Synergy Inverter is designed for smaller condensing unit dimensions to save the installation space at maximum of 28% from current product.

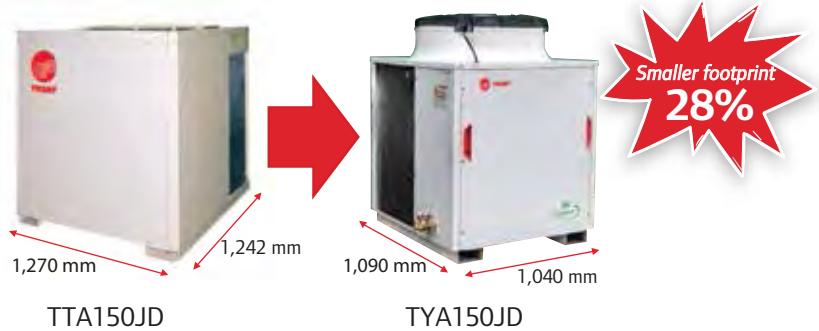

DC Compressor Inverter

An inverter air conditioner with variable speed compressor, the speed and tonnage can be adjustable according to the cooling demand and load on the air conditioner.

More comfortable, energy saving, ect.

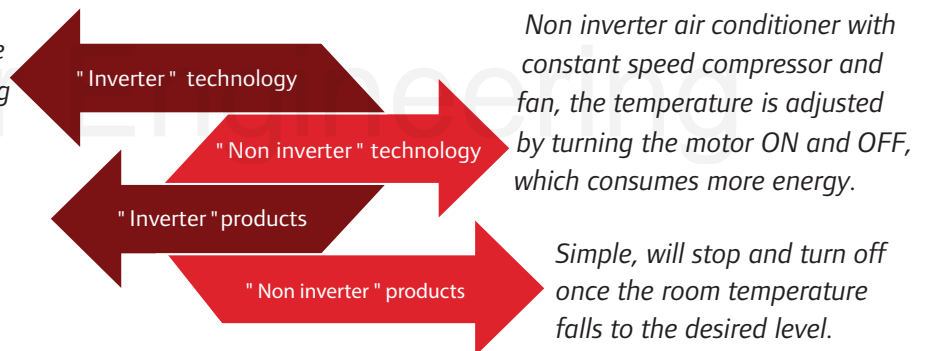

- DC inverter
- High energy efficiency
- High reliability
- Low noise / vibration

High Reliability with New Refrigerant Cooled PCB Technology

New full Package for top discharge and Micro Channel Radiator for side discharge design to enhance heat transfer area and decrease temperature by 15 °C.



Old : Crimping

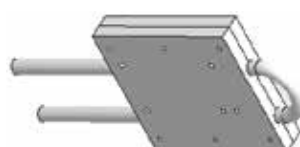

New for Top : Full Package



New for Side : Micro Channel Radiator

Easy service and maintenance

- Self - Diagnostic system shows error codes for the causes of malfunction which help reduce service time.

Completed DOL Starter and Controller

- Factory completed build-in DOL starter and digital wired controller. AHU starter shall be save for units with capacity not over than 240,000 Btu/h.



Digital Wired Controller
(Standard)



Remote Control (Option)

TYH Air Handling Unit

- For horizontal air discharge.
- Powder paint finished casing.
- Belt drive.
- Electronic Expansion Valve.
- Factory installed PCB, DOL starter and display wired controller.
- Suitable for ducted application (fan motor hp output will be specially selected to properly match with Free blow application).



TYH060PD-TYH075JD



TYH100JD-240JD

TYK/TYA Condensing Unit

- Powder paint finished casing.
- External current overload for compressor.
- Temperature protection.
- Under and Over voltage protection.
- Fully charged R410A refrigerant with shut-off valve.
- Hi/Low pressure.
- Phase protection.
- Refrigerant Cooled PCB.



TYKB60TD



TYA075-200JD
(1FAN)



TYA240JD
(2FAN)

Digital Wired Control Standard

- The control panel of wire controller is responsible for controlling the operation status of the system by the button and displaying the working status of the entire system by its LCD screen, and is responsible for communicating with the control board of the system.



Digital Wired Controller



Remote Control (Option)



LCD SCREEN



TURBO MODE



FAULT DISPLAY

Technique Index

- Temperature sensor: NTC.
- Temperature set range: 16-30°C.
- Compressor status.
- Signal Wire: Sheathed twisted pair cable, 24 AWG.
- Size: 96.7x95.7x41.3 mm. (Width x High x Thick).



CHILD LOCKED MODE



DAILY TIMER ON-OFF



WIRELESS REMOTE (OPTION)

Remote Control (Option)

- Wireless remote.
- Radiation distance: ≤ 10 meters.
- Temperature set range: 16-30°C.

Weekly Schedule Wired Controller TM-AT0BR (Optional)

- The control panel of wire controller is responsible for controlling the operation status of the system by the button and displaying the working status of the entire system by its LCD screen and is responsible for communicating with the control board of the system.
- Weekly schedule wired controller is applied to industrial, commercial, and family room temperature control.



LCD LARGE SCREEN

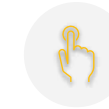

TOUCH BUTTON



IP20



TIMER AND WEEKLY SCHEDULE

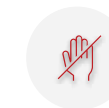

BUTTON LOCKED MODE



FAULT DISPLAY

Technique Index

- Temperature sensor: NTC.
- Temperature display precision: ±0.5 °C.
- Temperature set range: 16-30°C.
- Working environment: 0-50°C.
- IP Level: IP20.
- Signal Wire: Sheathed twisted pair cable, 24 AWG.
- Size: 86x86x41.3 mm. (Width x High x Thick).

Touch Screen Centralized Control System (Optional)

- Touch screen centralized control system is the centralized management system of synergy system.
- For unit system, it can provide group configuration, schedule management, user operation, energy saving control and other functions.
- 7 inch Touch Screen Panel.



Touch Panel F007



User Interface



COMPACT
STRUCTURE



USER-FRIENDLY
INTERFACE



ALL UNITS
CONTROL



GROUP DEVICE
CONTROL



TIMER AND
WEEKLY



ENERGY
SAVING MODE



ALARM

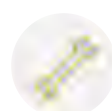

SYSTEM
DIAGNOSING

- Uses RS-485 network from, the structure is simple, the wiring is convenient and fast.
- Centralized touch screen, can control up to 64 stes.
- The longest transmission distance can reach 1,000 meters.

Integrated controller

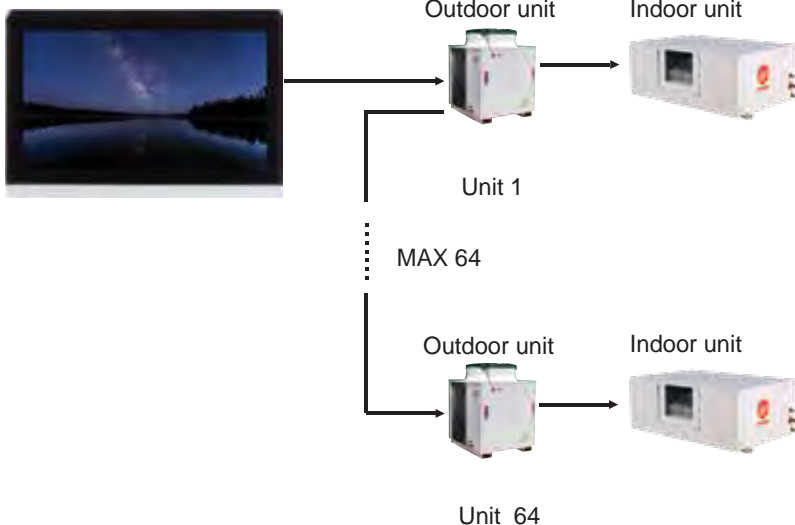

Product Dimension

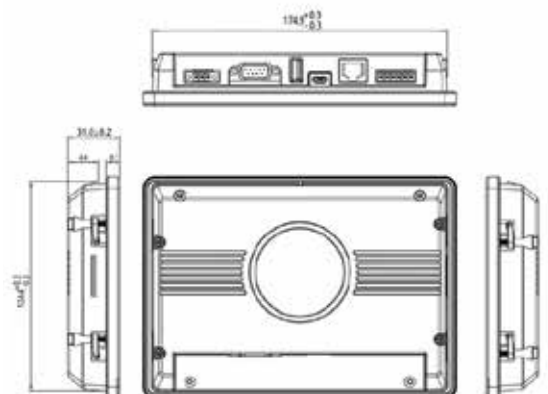

MYV Tall Floor Model

- New compact design that fits well for a variety of usages.
- Offers a silent operation with the Single Inlet Centrifugal Fan.
- The front unit can be opened, making it easy for maintenance to be carried out without any space constraints.



TYE Air Handling Unit (Single skin)

- Vertical discharge.
- Forward curved centrifugal type evaporator fan(s) with fixed belt drive.
- Suitable for ducted application (Fan motor hp output will be specially selected to properly match with Free blow application.)



CLCP Air Handling Unit (Double skin)

- Customizable for air discharge.
- Belt drive.
- High Static Pressure.
- Suitable for ducted application (Fan motor hp output will be specially selected to properly match with application.)



TYKB60TD



TYA075JD-TYA200JD



TYA240JD

TYK/TYA Condensing Unit

- External current overload for compressor.
- Temperature protection.
- Under and Over voltage protection.
- Fully charged R410A refrigerant with shut-off valve.
- Refrigerant Cooled PCB.
- Hi/Low pressure.
- Phase protection.

System Performance Table

Indoor model	Indoor motor (HP)	Outdoor model	Capacity (MBH)
MYV060	Direct drive motor	TYKF 60TD	60
MYV090	Direct drive motor	TYA 075JD	75
MYV090	Direct drive motor	TYA 100JD	100
MYV120	Direct drive motor	TYA 120JD	120
CLCP004	2	TYA 075JD	75
CLCP006	2	TYA 100JD	100
TYE120	2	TYA 120JD	120
TYE160	2	TYA 150JD	150
TYE210	3	TYA 200JD	200
TYE240	5.5	TYA 240JD	240
CLCP008	2	TYA 120JD	120
CLCP010	2	TYA 150JD	150
CLCP012	3	TYA 200JD	200
CLCP014	5.5	TYA 240JD	240

Product Specifications (TYH Model)

UNIT MODELS	Indoor unit		TYH060JD	TYH075JD	TYH100JD	TYH120JD	TYH160JD	TYH210JD	TYH240JD	
	Outdoor unit		TYK860TD	TYA075JD	TYA100JD	TYA120JD	TYA150JD	TYA200JD	TYA240JD	
Electrical Data	Power Supply	V/Ph/Hz	380-415/3/50							
Performance data	Cooling Capacity (Min-Max)	Btu/h	60,000 (30,000-65,000)	75,000 (35,000-80,000)	100,000 (40,000-100,000)	120,000 (48,000-120,000)	150,000 (60,000-150,000)	200,000 (80,000-200,000)	240,000 (96,000-240,000)	
	SEER	Btu/h/W	15.2	11.6	12.36	12.73	11.51	11.55	12.07	
	Nominal Airflow	CFM	2,000	2,500	3,400	4,000	5,300	7,000	8,000	
System data	Refrigerant Type		R410A (Fully charged)							
	No. Refrigerant Circuits		1	1	1	1	1	1	1	
	Refrigerant Connection Type		BRAZE	BRAZE	BRAZE	BRAZE	BRAZE	BRAZE	BRAZE	
	Suction Line OD	in (mm)	7/8"	7/8"	7/8"	11/8"	11/8"	13/8"	15/8"	
	Liquid Line OD	in (mm)	3/8"	3/8"	1/2"	1/2"	5/8"	5/8"	5/8"	
	Drain Connection Size	in (mm)	1 (25.4)	1 (25.4)	1 (25.4)	1 (25.4)	1 (25.4)	1 (25.4)	1 (25.4)	
	Drain Connection Type		Steel Pipe - MPT							
Indoor Units										
Flow control	Type		Electronics Expansion Valve							
Fan	Fan Type		Double Inlet Centrifugal with Forward Curved Wheel							
	Qty		1	2	2	2	2	2	2	
	Drive Type		Belt - Drive							
Fan Motor	Output	Hp (kW)	3/4 (0.55)	1 (0.75)	2 (1.5)	2 (1.5)	2 (1.5)	3 (2.2)	5.5 (4.0)	
	Qty x RLA		1.61	1.99	3.48	3.48	3.48	4.9	8.56	
Filter	Type		1-In Thickness Washable Aluminium							
Dimension (HxWxD)	Unit (Net)	mm	520x1,465x916	520x1,465x916	521x1,833x916	620x1,833x916	798x2,088x1,260	849x2,366x1,319		
Weight	Unit (Net)	kg	90	94	138	143	175	235	290	
Outdoor Units										
Compressor	Type		Twin Rotary DC Inverter					Scroll DC Inverter	Twin Rotary DC Inverter	
	Qty x RLA		9.8	14.5	19.0	22.9	31.3	35.3	2 x 23.7	
Fan	Fan Type		Propeller							
	Hot Air Discharge Direction		Horizontal (Front)			Vertical (Top)				
	Qty		2	1	1	1	1	1	2	
Fan Motor	Type		DC motor		AC motor					
	Output	Watt	100	650	650	650	1,050	1,580	2 x 650	
	Qty x RLA		2x1.26	1.5	1.5	1.5	1.9	3.6	2 x 1.5	
Dimension (HxWxD)	Unit (Net)	mm	1,430x940x340	1,215x900x841		1,382x900x841	1,370x1,040x1,090		1,378x1,792x881	
Weight	Unit (Net)	kg	102	140	141	152	175	200	290	

Product Specifications (MYV/CLCP Model)

UNIT MODELS	Indoor unit		MYB060BB	CLCP004	MYV090JB	CLCP006	MYV090JB	CLCP008	MYV120JB
	Outdoor unit		TYK860TD	TYA075JD	TYA75JD	TYA100JD	TYA100JD	TYA120JD	TYA120JD
Electrical Data	Power Supply	V/Ph/Hz	380-415/3/50						
Performance data	Cooling Capacity	Btu/h	60,000	75,000	75,000	100,000	100,000	120,000	120,000
	Nominal Airflow	CFM	2,000	2,500	2,500	3,400	3,400	4,000	4,000
System data	Refrigerant Type		R410A (Fully charged)						
	No. Refrigerant Circuits		1	1	1	1	1	1	1
	Refrigerant Connection Type		BRAZE	BRAZE	Sweat	BRAZE	Sweat	BRAZE	Sweat
	Suction Line OD	in (mm)	7/8"	7/8"	7/8"	7/8"	7/8"	1-1/8"	1-1/8"
	Liquid Line OD	in (mm)	3/8"	3/8"	3/8"	1/2"	1/2"	1/2"	1/2"
Indoor Units									
Flow control	Type		Electronics Expansion Valve						
Fan	Fan Type		Single Intel Centrifugal	Forward Curved Centrifugal	Single Intel Centrifugal	Forward Curved Centrifugal	Single Intel Centrifugal	Forward Curved Centrifugal	Single Intel Centrifugal
	Qty		1	1	2	1	2	1	2
	Drive Type		Direct Drive	Belt - Drive	Direct Drive	Belt - Drive	Direct Drive	Belt - Drive	Direct Drive
Fan Motor	Output	Watt	220	1,500	2x150	2,200	2 x 150	3,000	2x200
	Qty x RLA		1.65	-	2x1.78	-	2x1.78	-	2x2.34
Filter	Type		Polypropylene	1-In Thickness Washable Aluminium	Polypropylene	1-In Thickness Washable Aluminium	Polypropylene	1-In Thickness Washable Aluminium	Polypropylene
Dimension (HxWxD)	Unit (Net)	mm	1,900x848x400	868x1,058x1,368	1,900x848x400	868x1,058x1,368	1,900x848x400	868x1,058x1,368	1,900x848x400
Weight	Unit (Net)	kg	100	200	136.3	260	136.3	300	143.3
Outdoor Units									
Compressor	Type		Twin Rotary DC Inverter						
	Qty x RLA		9.8	14.5	14.5	19.0	19.0	22.9	22.9
Fan	Fan Type		Propeller						
	Hot Air Discharge Direction		Horizontal (Front)			Vertical (Top)			
	Qty		2	1	1	1	1	1	1
Fan Motor	Type		DC motor		AC motor				
	Output	Watt	100	650	650	650	650	650	650
	Qty x RLA		2x1.26	1.5	1.5	1.5	1.5	1.5	1.5
Dimension (HxWxD)	Unit (Net)	mm	1,430x940x340	1,215x900x841	1,215x900x841	1,215x900x841	1,215x900x841	1,382x900x841	1,382x900x841
Weight	Unit (Net)	kg	102	140	140	141	141	152	152

Product Specifications (TYE/CLCP Model)

UNIT MODELS	Indoor unit		TYE120JD	CLCP010	TYE160JD	CLCP012	TYE210JD	CLCP014	TYE240JD
	Outdoor unit		TYA120JD	TYA150JD	TYA150JD	TYA200JD	TYA200JD	TYA240JD	TYA240JD
Electrical Data	Power Supply	V/Ph/Hz	380-415/3/50						
Performance data	Cooling Capacity	Btu/h	120,000	150,000	150,000	200,000	200,000	240,000	240,000
	Nominal Airflow	CFM	4,000	5,000	5,000	7,000	7,000	8,000	8,000
System data	Refrigerant Type		R410A (Fully charged)						
	No. Refrigerant Circuits		1	1	1	1	1	1	1
	Refrigerant Connection Type		BRAZE	BRAZE	BRAZE	BRAZE	BRAZE	BRAZE	BRAZE
	Suction Line OD	in (mm)	1-1/8"	1-1/8"	1-1/8"	1-3/8"	1-3/8"	1-3/8"	1-3/8"
	Liquid Line OD	in (mm)	1/2"	5/8"	5/8"	5/8"	5/8"	5/8"	5/8"
Indoor Units									
Flow control	Type		Thermostatic Expansion Valve						
Fan	Fan Type		Forward Curved Centrifugal	Forward Curved Centrifugal	Forward Curved Centrifugal	Forward Curved Centrifugal	Forward Curved Centrifugal	Forward Curved Centrifugal	Forward Curved Centrifugal
	Qty		1	1	1	1	2	1	2
	Drive Type		Belt - Drive	Belt - Drive	Belt - Drive	Belt - Drive	Belt - Drive	Belt - Drive	Belt - Drive
Fan Motor	Output	Watt	1,492	5,500	1,492	5,500	2,238	5,500	4,103
	Qty x RLA		3.67	-	4.90	-	4.90	-	8.56
Filter	Type		1-In Thickness Washable Aluminium						
Dimension (HxWxD)	Unit (Net)	mm	1,523x1,410x635	1,178x1,368x1,523	1,751x1,613x850	1,178x1,678x1,523	1,751x2,210x702	1,178x1,988x1,523	1,751x2,210x702
Weight	Unit (Net)	kg	154	330	275	420	356	470	365
Outdoor Units									
Compressor	Type		Twin Rotary DC Inverter			Scroll DC Inverter		Twin Rotary DC Inverter	
	Qty x RLA		22.9	31.3	31.3	35.3	35.3	23.7	23.7
Fan	Fan Type		Propeller						
	Qty		1	1	1	1	1	1	1
Fan Motor	Type		AC motor						
	Output	Watt	650	1,050	1,050	1,580	1,580	2x650	2x650
	Qty x RLA		1.5	1.9	1.9	3.6	3.6	2x1.5	2x1.5
Dimension (HxWxD)	Unit (Net)	mm	1,382x900x841	1,370x1,040x1,090	1,370x1,040x1,090	1,370x1,040x1,090	1,370x1,040x1,090	1,378x1,792x881	1,378x1,792x881
Weight	Unit (Net)	kg	152	175	175	200	200	290	290

- Note:
1. Capacity is rated at ARI conditions of 80 °FDB /67 °FWB for Indoor & 95 ° FDB for Outdoor.
 2. Outdoor unit dimensions depth is not included the dimensions of unit's legs.
 3. Product design and specification are subject to change without notice.
 4. The actual sizing of CLCP model is depends on the design airflow cfm.



Trane (Thailand)

1126/2, 30th-31st Fl., Vanit Building 2, New Petchburi Road, Makkasan, Ratchtheevee, Bangkok, 10400

☎ 0-2761-1111

